

**CUSTOMER COPY**

REV.	DESCRIPTION	BY/DATE	CHECK/DATE	APPROVED/DATE
1.0	D-0946	Weison Feb,17,05		

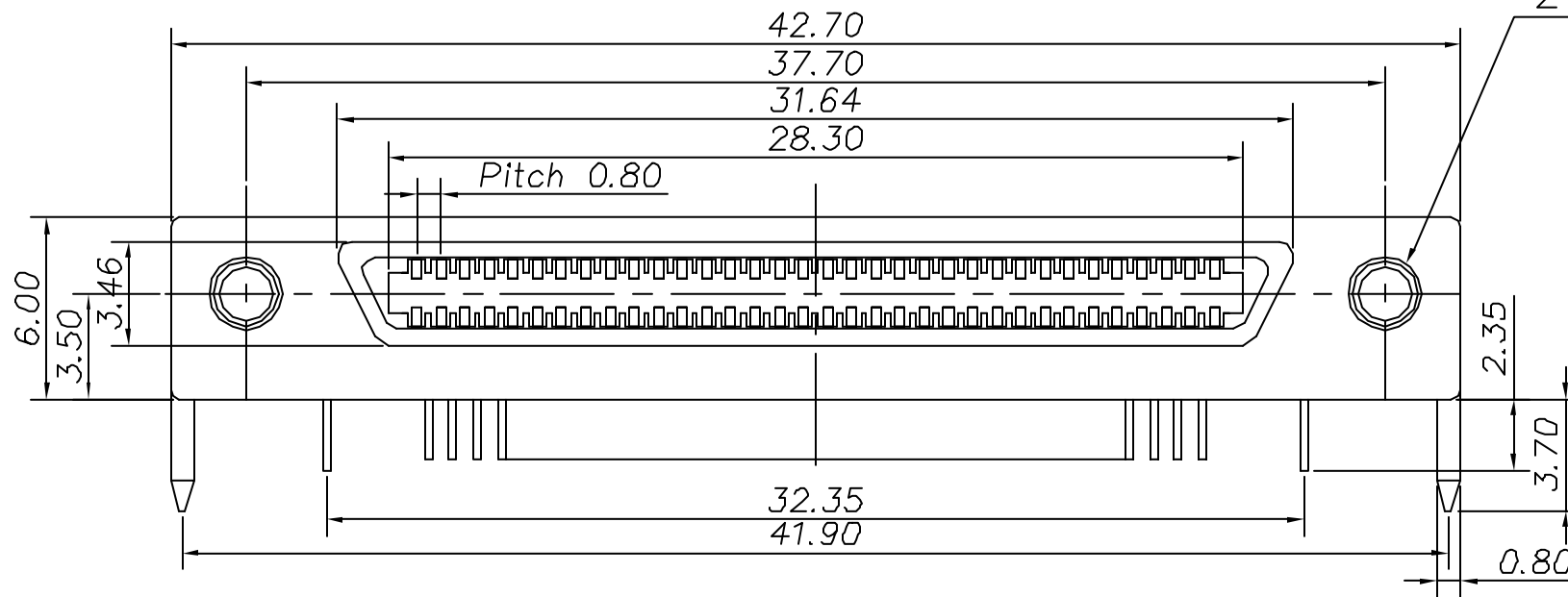
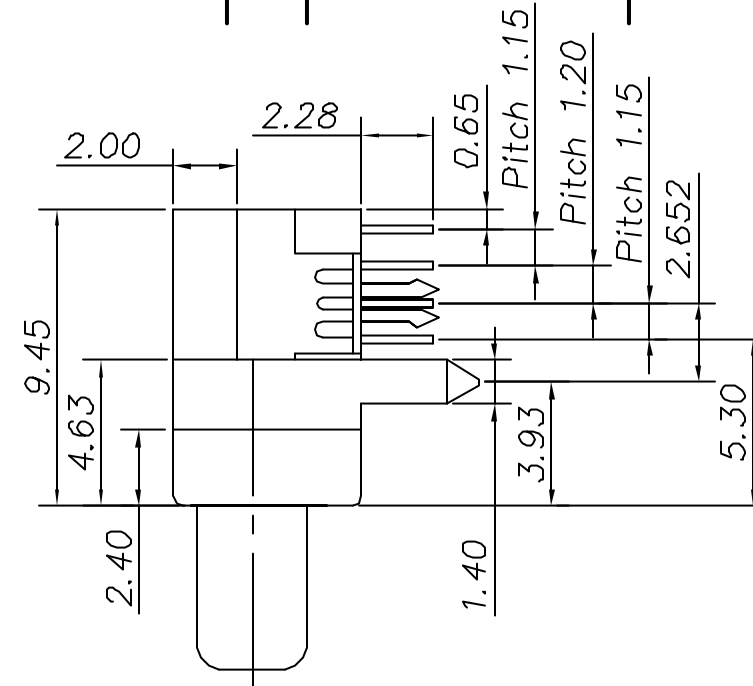
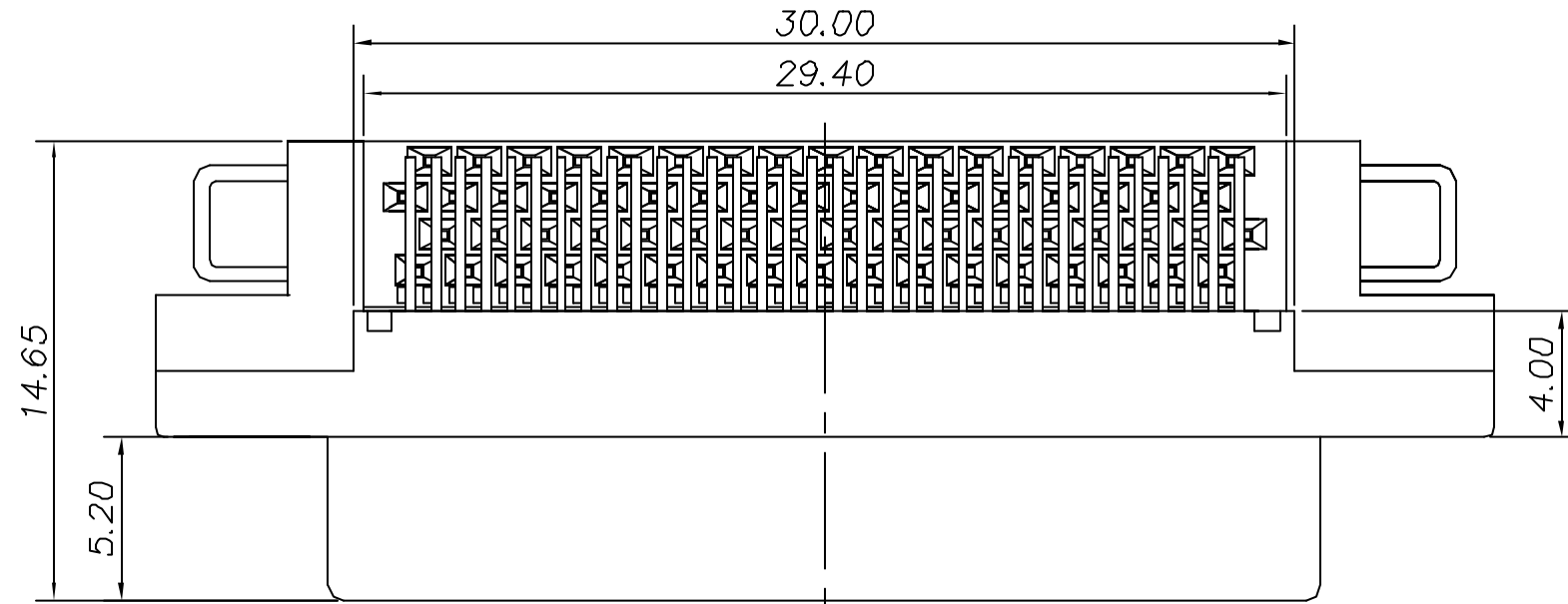

M2\*0.4-6H THREAD  
2 PLC,

NOTES:

- MATERIAL:  
INSULATOR : P.B.T & GLAS-FIBER REINFORCED UL 94V-0  
CONTACT : PHOSPHOR BRONZE, GOLD OVER NICKEL
- Electrical Specifications:  
RATED CURRENT: 0.30A  
INSULATION RESISTANCE: 500M OHMS MIN  
CONTACT RESISTANCE: 50M OHMS MAX  
DIELECTRIC WITHSTANDING VOLTAGE: 250V AC FOR 1 MINUTE  
OPERATING TEMPERATURE: -55°C-- +85°C

General Tolerance	Angle Tolerance	Dwg	Date	<b>COMOSS®</b> COMOSS ELECTRONIC CO., LTD. 4F., No. 11, Chung-Hsin St., ShuLin 238, Taipei, Taiwan R.O.C. Item 0.8mm CHAMP RIHGT ANGEL CONN, MINI CONNECTOR R/A D.C.B TYPE Dwg. No. A02006 Part No. VHDR-X-N-X-X
.X ±0.15	.X° ±1.0°	Weison, Jan, 11, 05'		
.XX ±0.13	.XX° ±0.5°	Design Weison, Jan, 11, 05'		
.XXX ±0.05	.XXX° ±0.2°	CHK	Date	
SHEET 1/2		APP	Date	
FINISH See Notes				
Scale N/A	Unit: mm			
				SIZE A3
				REV 1.0

Drawing is subject to change without notice. Any updated information required, please contact with our sales dept.

**CUSTOMER COPY**

REV.	DESCRIPTION	BY/DATE	CHECK/DATE	APPROVED/DATE
1.0	D-0946	Weison Feb,17,05		

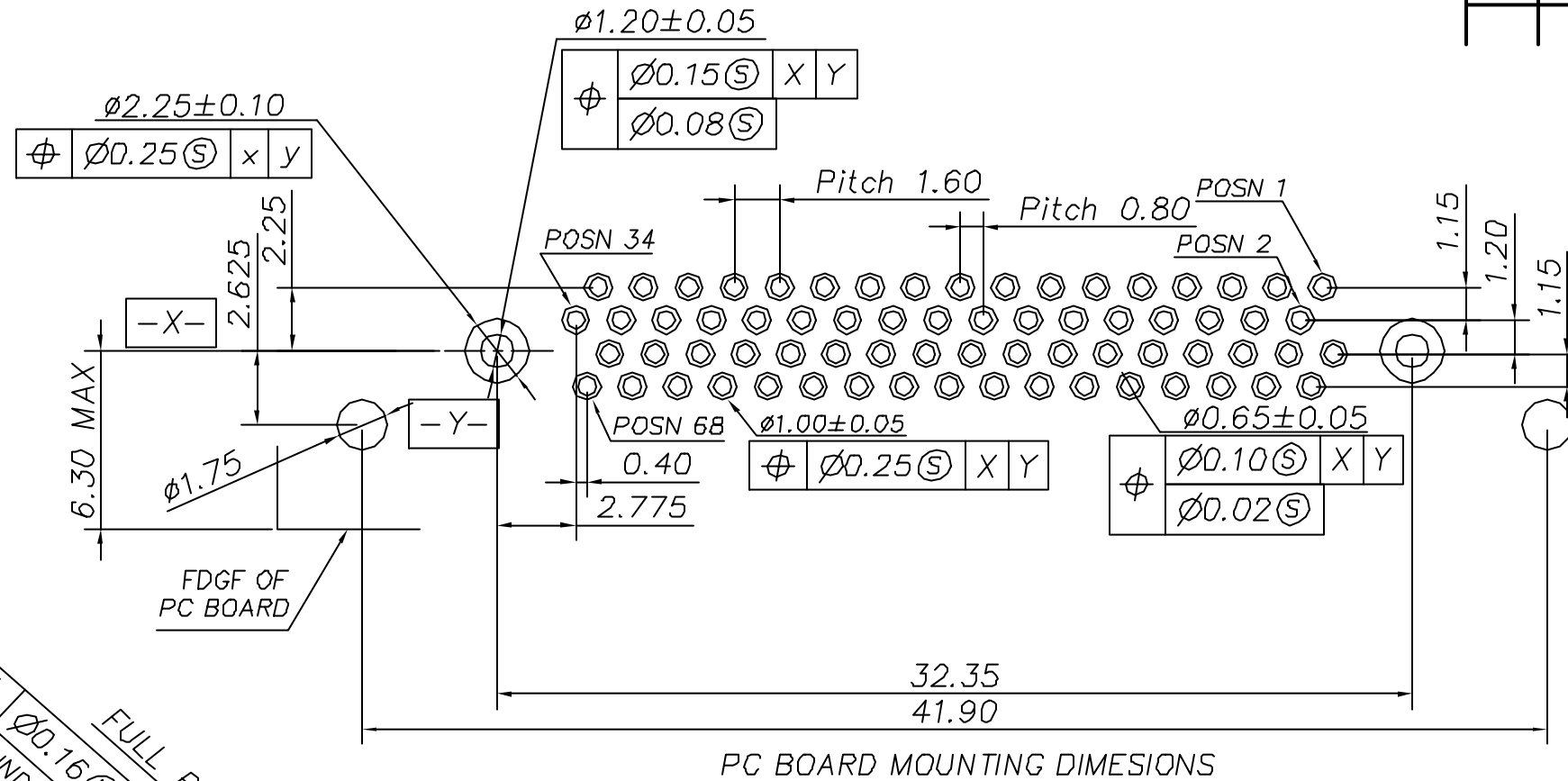

$\phi \ 0.16 \text{ (M)}$  | FULL R  
 $\text{E (S)}$  | D (M)  
 PLC INDIVIDUALLY

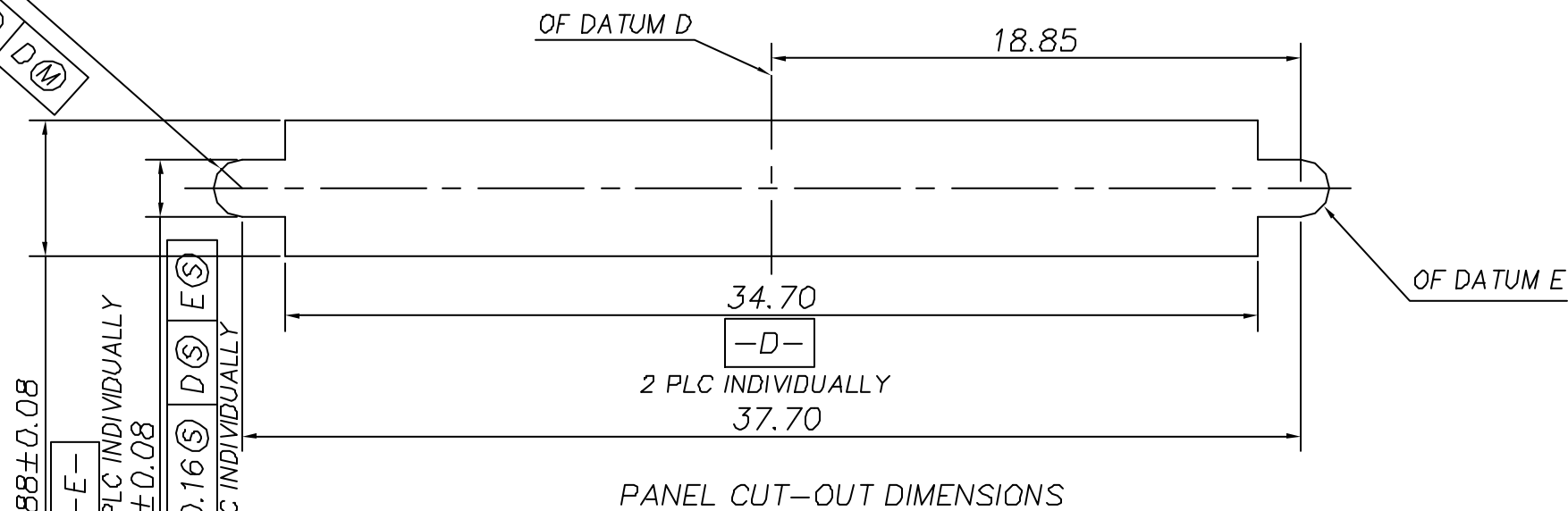

<b>General Tolerance</b>	<b>Angle Tolerance</b>	<b>Dwg</b>	<b>Date</b>	<b>COMOSS®</b> COMOSS ELECTRONIC CO., LTD. 4F., No. 11, Chung-Hsin St., ShuLin 238, Taipei, Taiwan R.O.C. Item 0.8mm CHAMP RIHGT ANGEL CONN, MINI CONNECTOR R/A D.C.B TYPE
.X ±0.25	.X° ±1.0°	Weison, Jan, 11, 05'		
.XX ±0.13	.XX° ±0.15°	<b>Design</b>	<b>Date</b>	
.XXX ±0.02	.XXX° ±0.02°	Weison, Jan, 11, 05'		
SHEET 2/2		<b>CHK</b>	<b>Date</b>	Dwg. No. A02006 <b>SIZE</b> A3 Part No. VHDR-X-N-X-X <b>REV</b> 1.0
FINISH See Notes		<b>APPR</b>	<b>Date</b>	
Scale N/A	Unit: mm			

Drawing is subject to change without notice. Any updated information required, please contact with our sales dept.